

LED Linear Lamp

Advantages

- The lamp is designed in linear style, which is combined LED lighting with building harmoniously.
- The lamp body, in fashionable design, is made of 6063 section aluminum and environmental protection PC cover.
- The lamp body length can be 600mm, 900mm, 1200mm and 1500mm optional according to demand.
- The installation is easy and safe with male and female connectors.
- The beam angle can be 110° in flood lighting, 30° 60° 90° in lens or 25° in beam split.
- The lamp is widely applicable in office, shopping mall, supermarket, school, hospital and other public buildings.



LTE Series



Standard:

LENGTH: 0.6/0.9/1.2/1.5m

POWER: 16 /36 /60 /72W



LTG Series

Standard:

LENGTH: 0.6/0.9/1.2/1.5m

POWER: 16 /36 /60 /72W

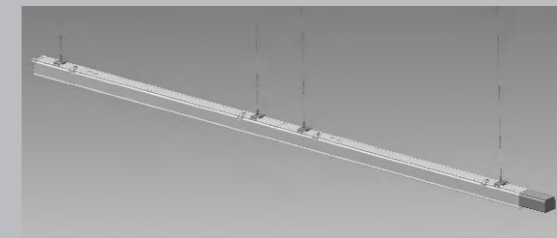

Suspended Installation



Ceiling Mounting

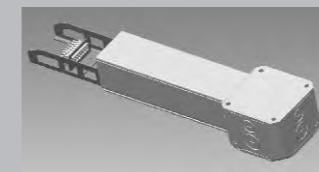

Power connector

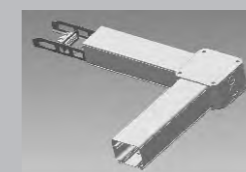

"L" connector



"T" connector

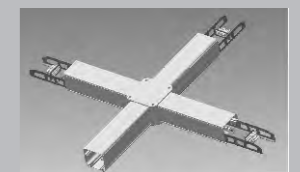

"+" connector



LED Linear Lamp

Advantages

- Create a circle of light from a line of LED Downlights
- A narrow line of nano LED Downlights for pure minimalism
- Superior glare control for high performance and visual comfort
- Three choices of beam angle 15°/30°/45°

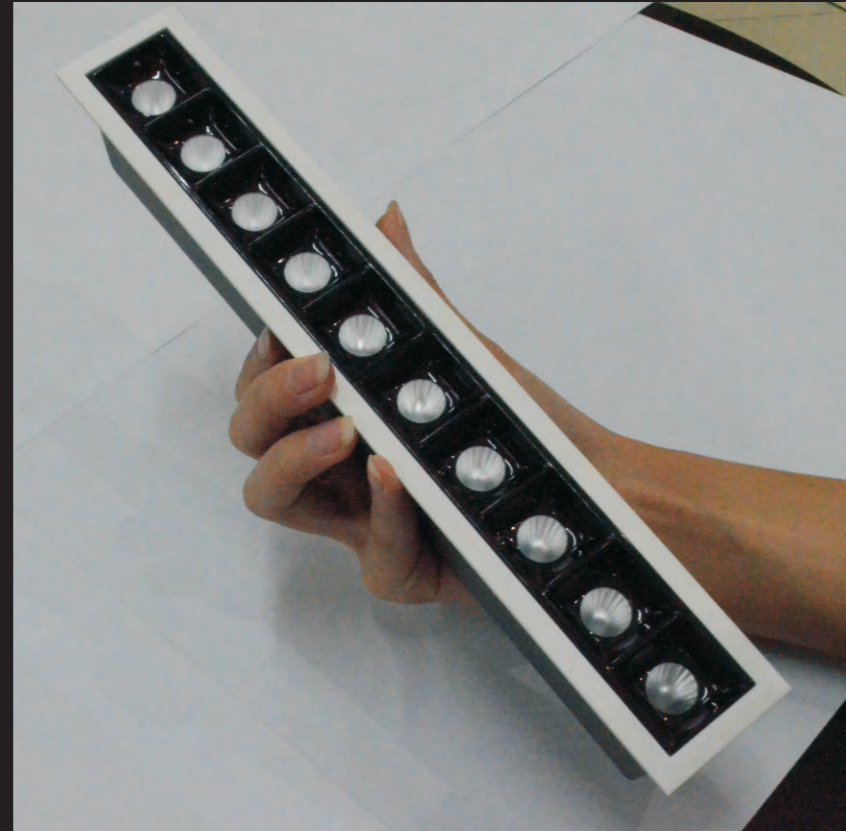

LTD Series

LTD0102
1LED/2W/180lm
37x37mm

LTD0104
2LED/4W/360lm
68x37mm

LTD0510
5LED/10W/900lm
140x37mm

LTD1020
10LED/20W/1800lm
273x37mm

LTD1530
15LED/30W/2700lm
405x37mm